

Soils Map-CSR2

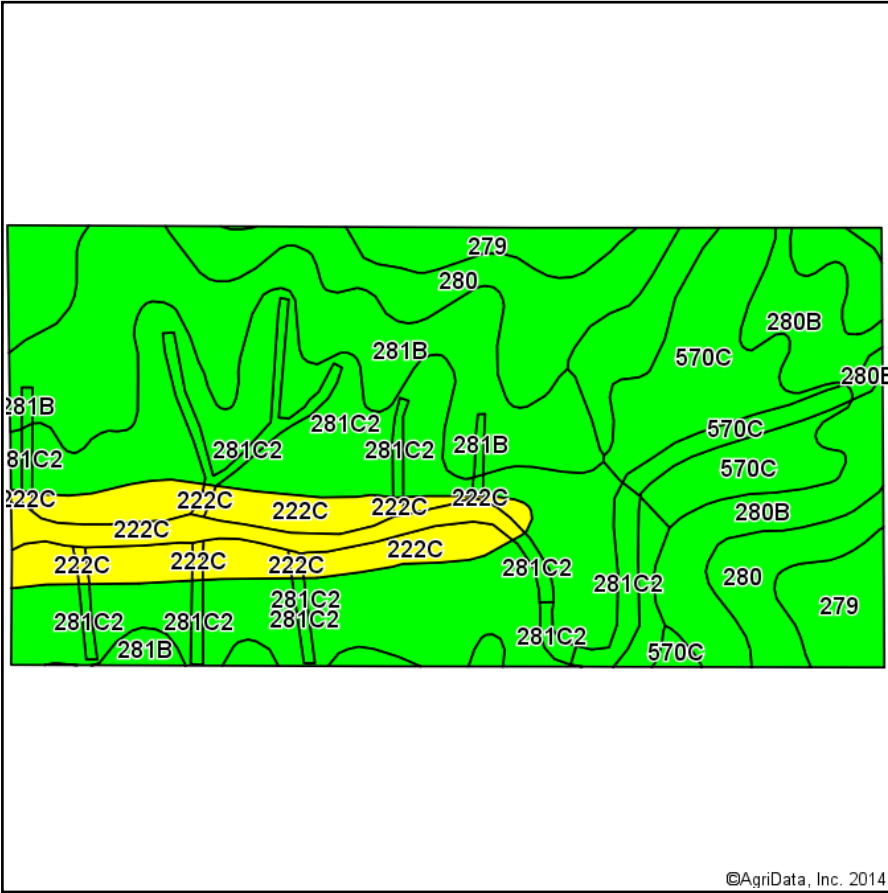

Soils data provided by USDA and NRCS.

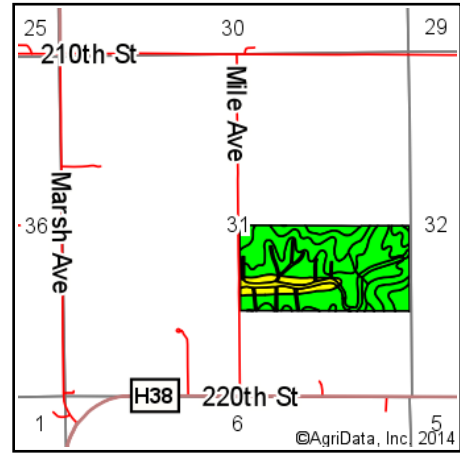

State: **Iowa**
 County: **Henry**
 Location: **31-72N-5W**
 Township: **Canaan**
 Acres: **79.42**
 Date: **9/26/2014**

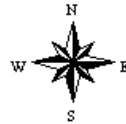

Maps Provided By:
surety
 CUSTOMIZED ONLINE MAPPING
 © AgriData, Inc. 2014 www.AgriDataInc.com

Area Symbol: IA087, Soil Area Version: 18

| Code | Soil Description | Acres | Percent of field | **CSR2 Legend | Non-Irr Class | CSR2** | CSR |
|-------------------------|---|-------|------------------|---------------|---------------|-------------|-------------|
| 281C2 | Otley silty clay loam, 5 to 9 percent slopes, moderately eroded | 24.89 | 31.3% | | IIIe | 82 | 70 |
| 281B | Otley silty clay loam, 2 to 5 percent slopes | 13.43 | 16.9% | | Ile | 91 | 90 |
| 280 | Mahaska silty clay loam, 0 to 2 percent slopes | 10.93 | 13.8% | | I | 90 | 95 |
| 280B | Mahaska silty clay loam, 2 to 5 percent slopes | 8.72 | 11.0% | | Ile | 87 | 90 |
| 222C | Clarinda silty clay loam, 5 to 9 percent slopes | 8.71 | 11.0% | | IVw | 46 | 30 |
| 570C | Nira silty clay loam, 5 to 9 percent slopes | 8.35 | 10.5% | | IIIe | 76 | 72 |
| 279 | Taintor silty clay loam, 0 to 2 percent slopes | 4.39 | 5.5% | | IIw | 83 | 88 |
| Weighted Average | | | | | | 80.6 | 75.8 |

Area Symbol: IA087, Soil Area Version: 18

**IA has updated the CSR values for each county to CSR2.

Field borders provided by Farm Service Agency as of 5/21/2008. Aerial photography provided by Aerial Photography Field Office.